



## Protein skimmer user manual

Product's name: External Hang on protein skimmer **QQ1**

Valid aquarium: 100L

Pump model: BUBBLE-MAGUS ROCK SP600

Thank you for using BUBBLE – MAGUS products, please read User manual carefully before use

Contain: A suit of collection cup, a suit of skimmer body and cover, one air intake hose, one overflow hose, one silencer, a suit of water inlet pipe, one outlet pipe, two sponges, one SP600 pump and Instruction.

### Assembly:

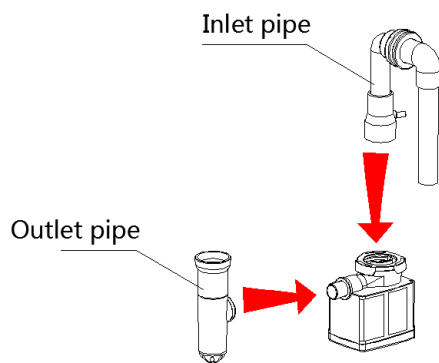

1. Insert outlet pipe into pump's outlet and inlet pipe insert to pump's inlet.

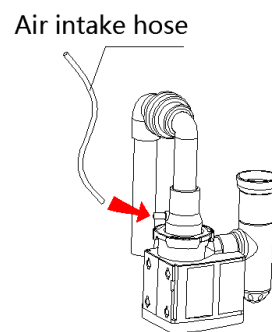

2. Connect air intake hose with air intake fitting on the inlet pipe.

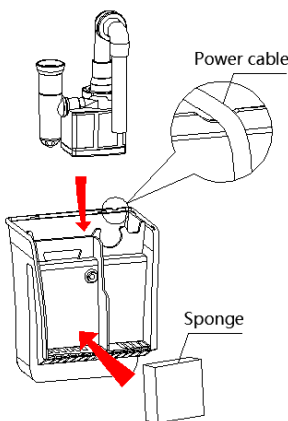

3. Put completed pump into the skimmer body, put sponge on the outlet position of body.

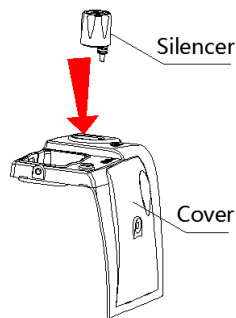

4. The silencer install on the top of cover.

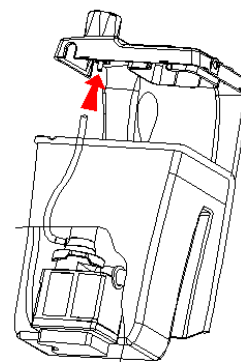

5. Connect another end of air intake hose to the silencer. Please notice to the hose should keep straight for air into smoothly.

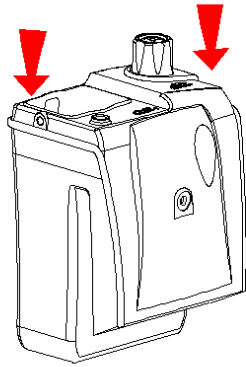

6. Put the cover on the body.

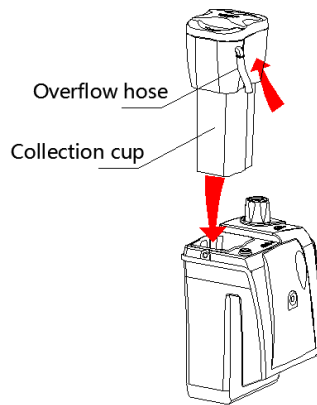

7. Collection cup put on the skimmer body and connect overflow hose to the elbow on the cup.

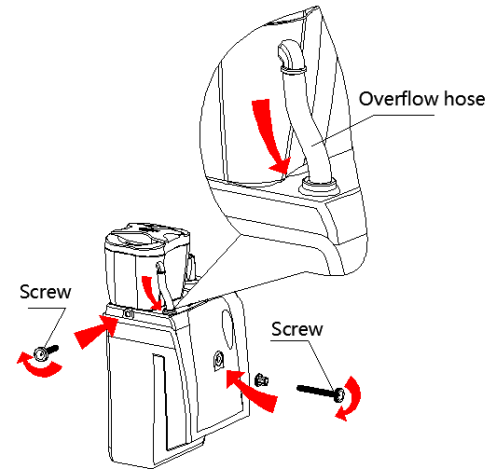

8. Fitting cover and screw on the collection cup  
(Notice: do not screw too over avoid to broken body).

## The first use:

Notice: Please don't excess to distance of water level to hang on bracket in the 35mm Max. (As picture indicated)  
It is cause to pump fail to work if the water level too lower.

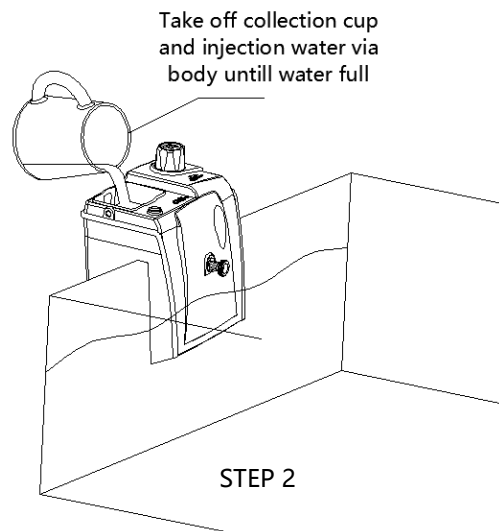
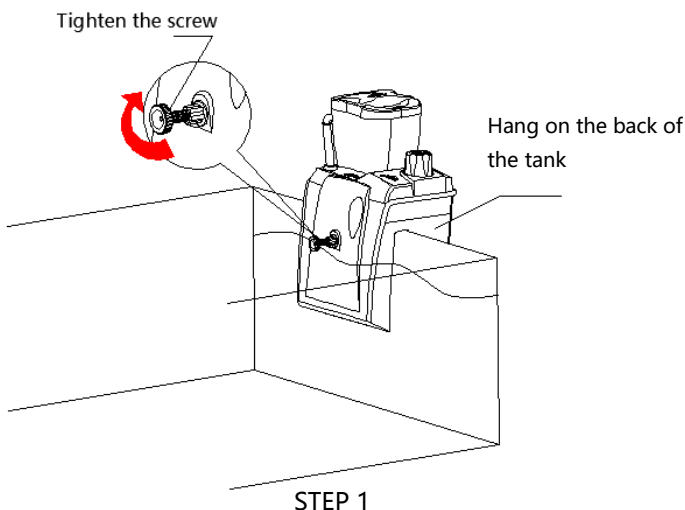
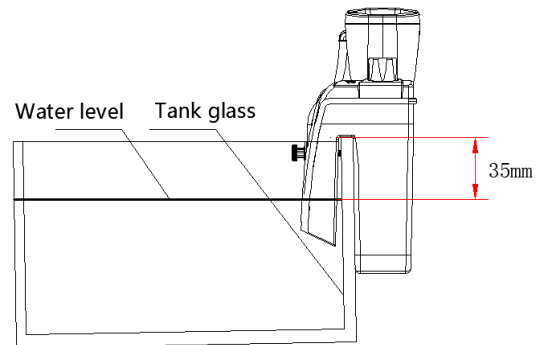

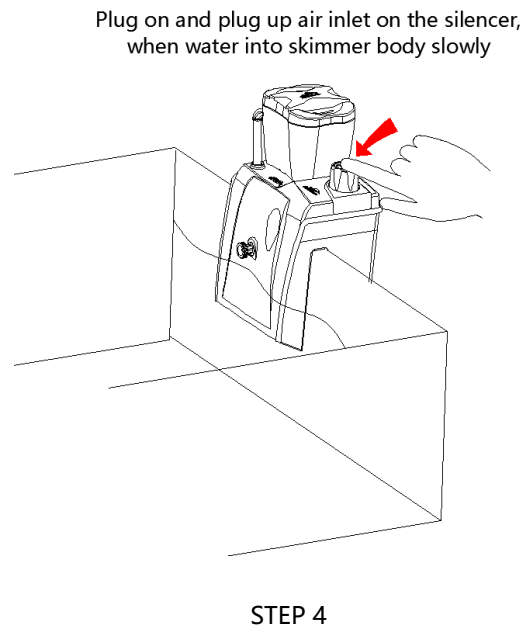
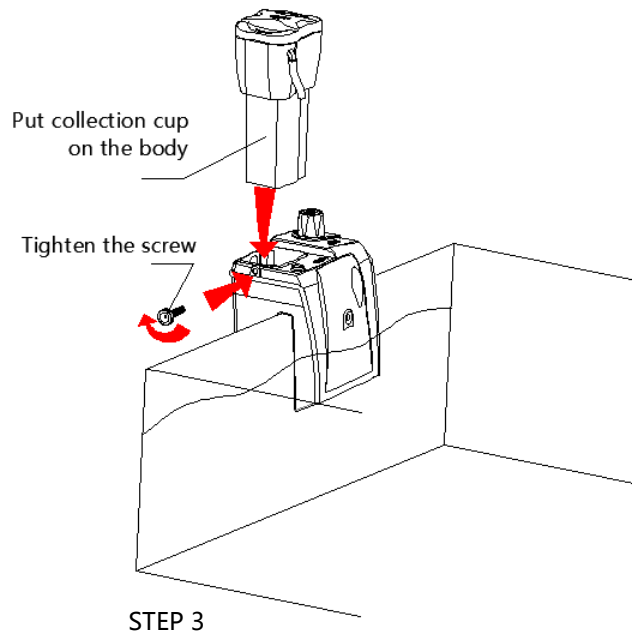

When water on the body go up and overflow from outlet, air empty on the pipe, then open the air inlet of silencer

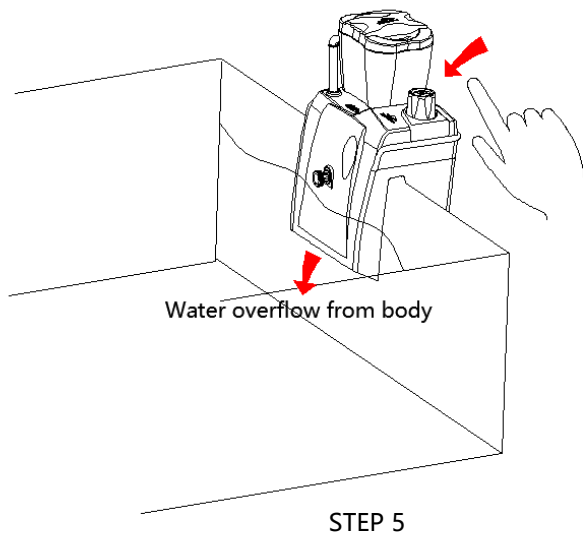

Make sure collection cup on the suitable position and tighten the screw.

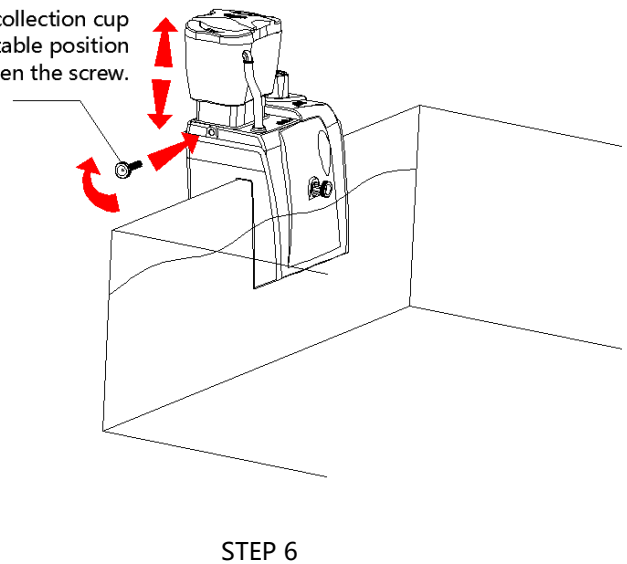

The skimmer start-up and then stop pump work, there are some water on the body and pipes. The skimmer will be work immediately when you restart to pump and needn't operate as used first time. But if body and pipe are empty as without water, we still have to operate as used first time.

The collection cup has to clean often, make sure connect outlet pipe correction please. If excessive wastewater or water quality abnormal cause to "Burst", the wastewater will return back to aquarium via overflow pipe avoid to outside of aquarium.



**Notice:**

1. Please don't excess to distance of water level to hang on bracket in the 35mm Max. It is cause to pump fail to work if the water level too lower.
2. Please must open air intake tube after pump work normally, otherwise the water will overflow out.
3. If installation is correct, it should appear much bubble quickly when pump start up. If no bubble or pump makes a noise or strenuous shake, please stop and restart up. If it can't solve the problem, please contact dealer or our technology person.
4. **Strictly prohibit pump operate without water.**
5. Every product tested before leaving factory, so some water blob maybe leave on it. It's not used vestige and wouldn't affect use.
6. Just start to use a few days its result maybe is no very good, this is a normal phenomenon. After a few days it can be normal working, if washing completely skimmer inside, this time will be reduced.
7. Please adjust bubble level according to aquaria's pollute. Don't adjust water level too high avoid water quality fluctuate cause much water effused.
8. Please wash collection cup at the fixed date, if sludge heaped inside the collection neck it will affect used result. Suggest cleaning skimmer body and pump every one or two month, don't use chemical to clean protein skimmer.
9. Please keep warranty card safety for guarantee used.